

**POF-0600 FLANGE**  
**65-45-12 DUCTILE IRON**  
**FITS STANDARD 6" ANSI**  
**FLANGES.**  
**USABLE WITH 2"**  
**GUIDE RAIL**

**SP-0600 SEALING RING**  
**NON-CORROSIVE**  
**300 SERIES SST**  
**BOLT IN DESIGN**  
**(STANDARD)**

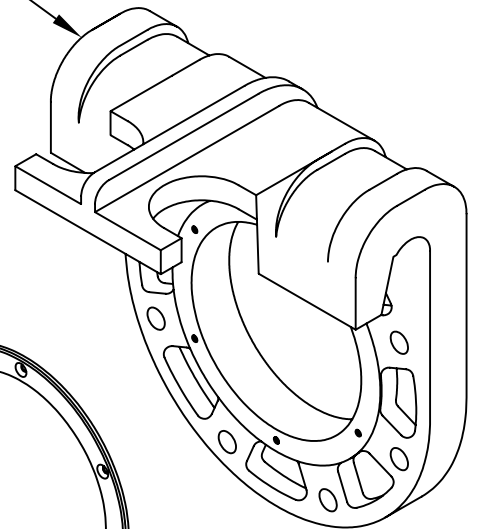

**SP-0600-R SEALING RING**  
**NON-CORROSIVE**  
**BUNA-N RUBBER**  
**BOLT IN DESIGN**  
**(OPTIONAL)**

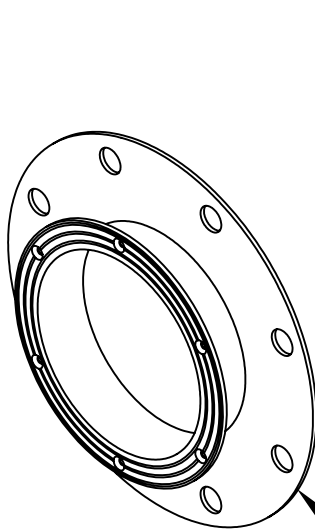

**FG-0600 GASKET**  
**NON-CORROSIVE**  
**BUNA-N RUBBER**  
**(OPTIONAL)**

ALL INFORMATION CONTAINED IN THIS DRAWING IS  
 CONFIDENTIAL AND PROPRIETARY TO CONERY MFG, INC.



CHANGES	TOLERANCES	DRAWN BY	DATE
F	DECIMALS	D. MIDDLETON	03/17/07
E	.XXX = ±.005	MATERIAL SPECIFICATION:  AS NOTED	
D	.XX = ±.010		
C	FRACTIONAL		
B	X/X = ±.1/64		
A	ANGLES		
	X' = ±1/2'		

**SPECIFICATION SHEET**  
**DIMENSIONAL DATA**

SCALE:	PART NO.
<b>NONE</b>	<b>PULL-OUT FLANGE</b>